



CNS-WHT-959JSPP

SPECIFICATION DATA SHEET

PRODUCT DETAILS

Manufacturer :	Jaquar	Type:	Wall Hung WC
Colour:	White	Flush valves	Regular, Dual & I Flush advantages
Outlet	Horizontal	Material:	Ceramic - Vitreous China
Technical Details:	Internal diameter of inlet hole dia. $\varnothing 58 \pm 3$ mm External diameter of outlet hole dia. $\varnothing 100 \pm 5$ mm		

PRODUCT IMAGE

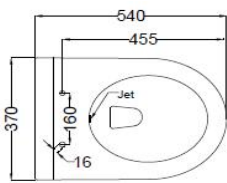

TOP VIEW

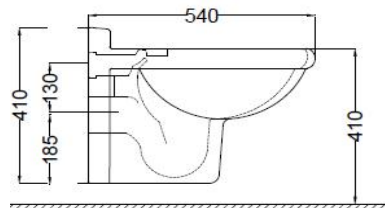

SIDE VIEW

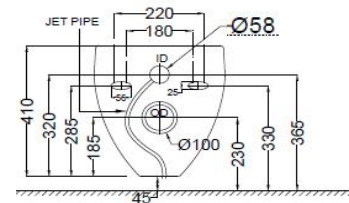

BACK VIEW

Product Dimension	370x540x410 mm	FEATURES
Product Weight	19.5 kg	Box Rim with In-built jet ,Dual Flush-3/6 LPF,Anti germ glaze.

ACCESSORIES INCLUDED

PP Soft Close Seat cover	CNS-WHT-115S
Inlet & Outlet gasket	ZPS-WHT-GK01
Jet Pipe	ZPS-WHT-5601

ACCESSORIES EXCLUDED

Rag bolt	ZPS-MST-RB07
Concealed cistern model no	JCS-WHT-2400S,2400FS,2400WS

CERTIFICATION

Compliance : EN 997:2012 + A1:2015 (E), SANS 497:2011

All technical dimensions are in accordance to British standards, Bureau of Indian Standards



DISCLAIMER: Our every effort has been made to ensure factual accuracy, the information presented subject to changes due to requirements in different sites, markets and/ or countries. All dimensions are in mm (Tolerance ± 5 MM). Jaquar reserves the right to make the necessary amendments at any time without prior notice.